

Stage 1

glue with colour inside

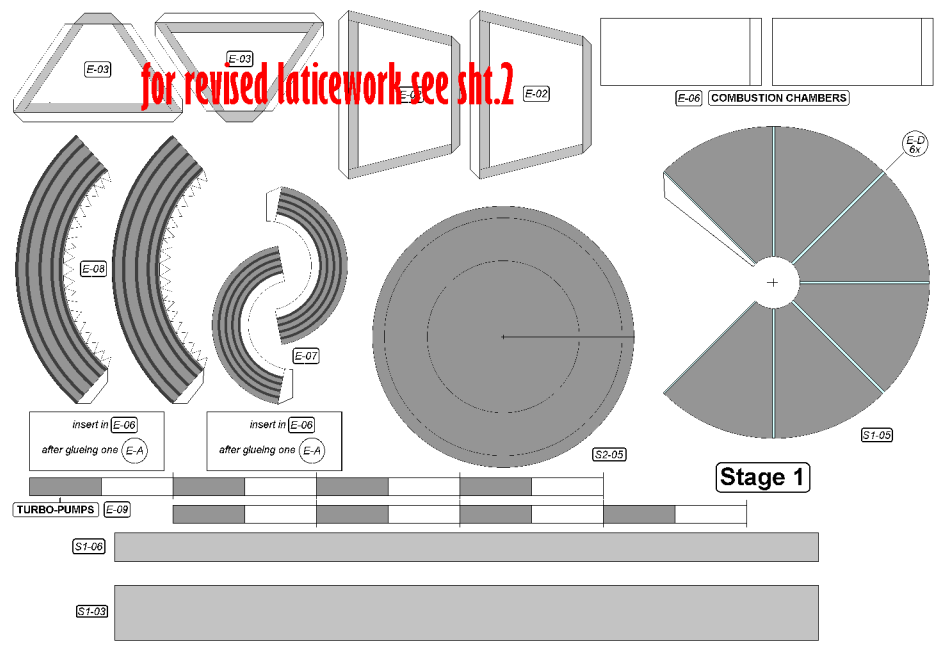
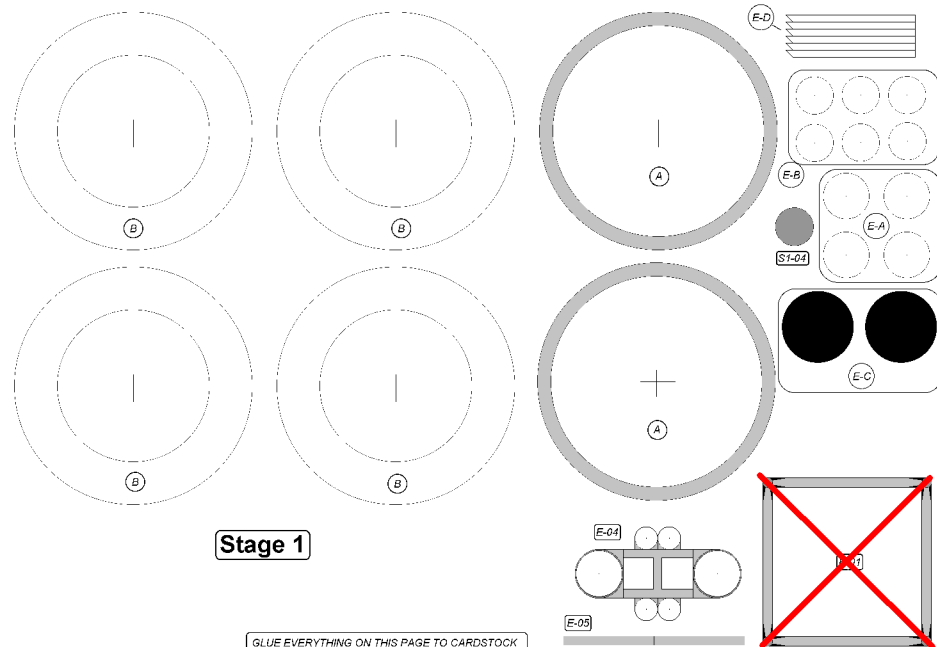
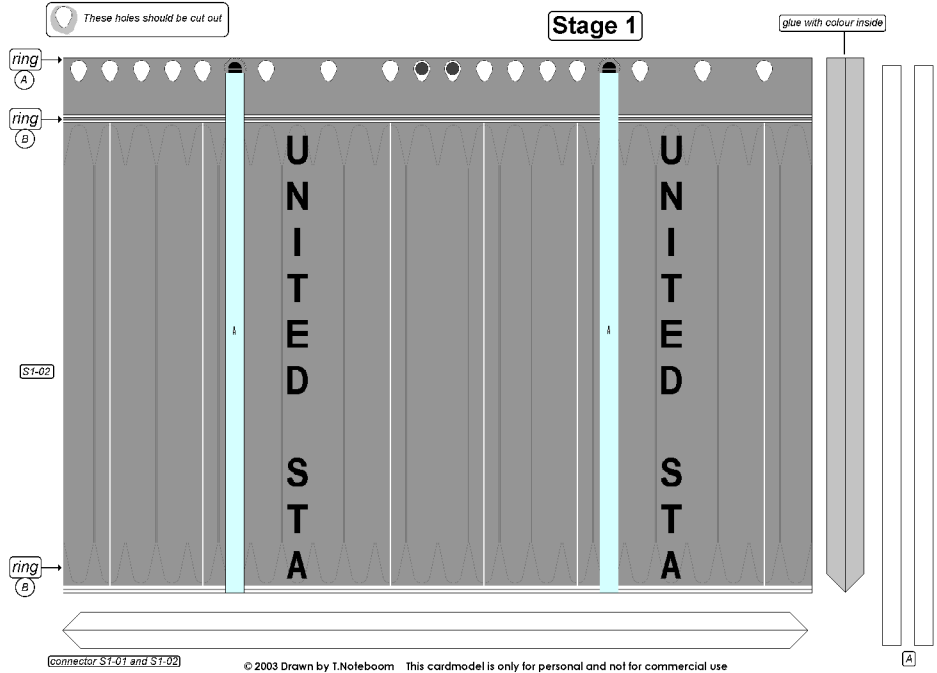
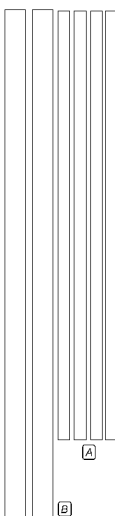

* reinforce these parts after placing inside rings

Interstage

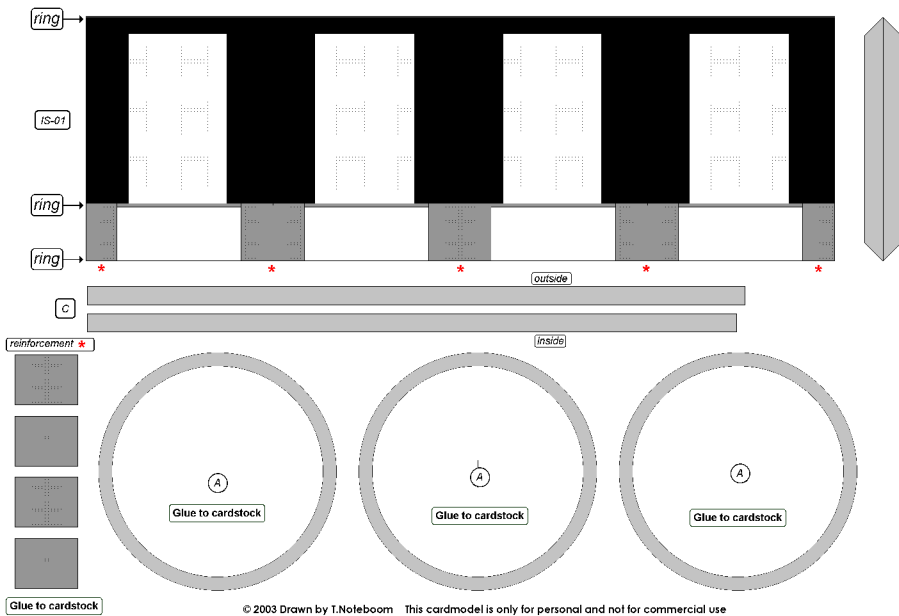

Stage 2

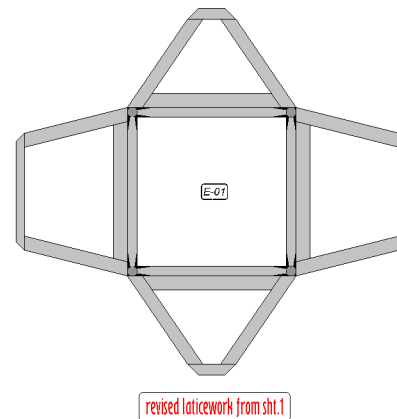
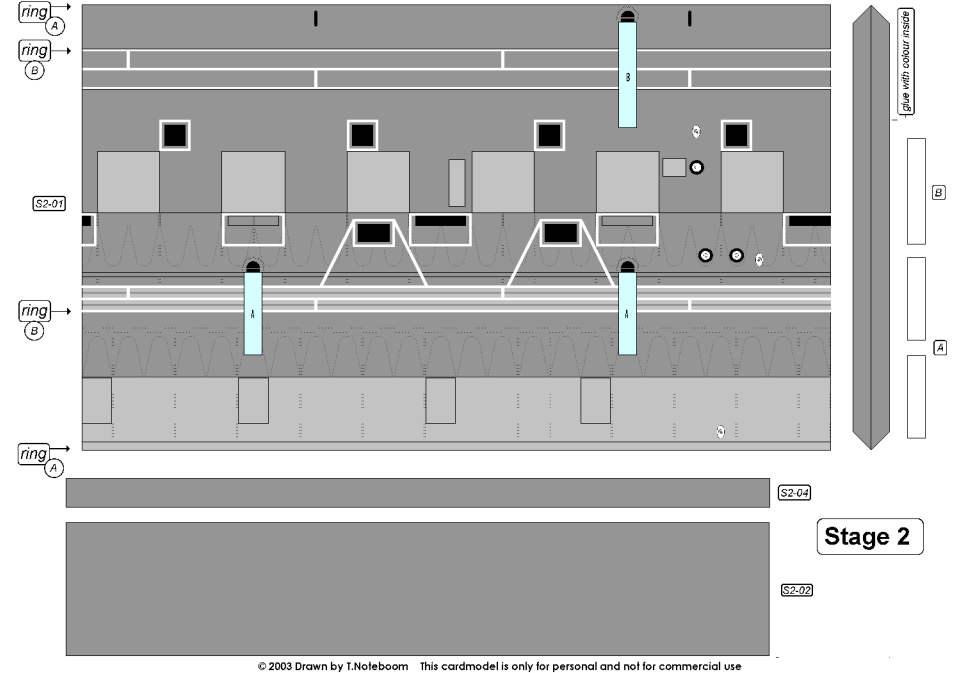
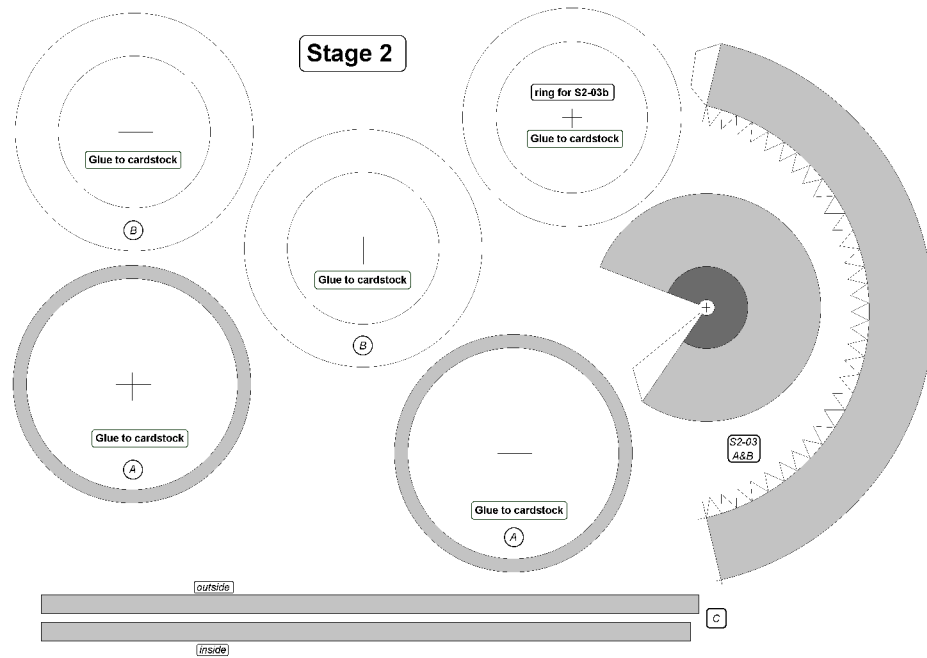

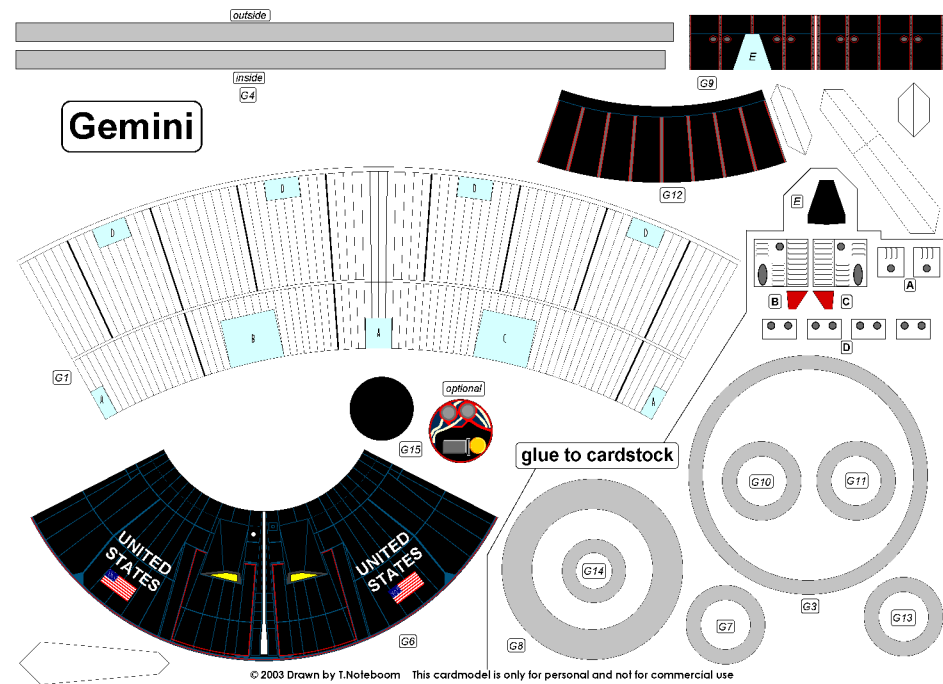
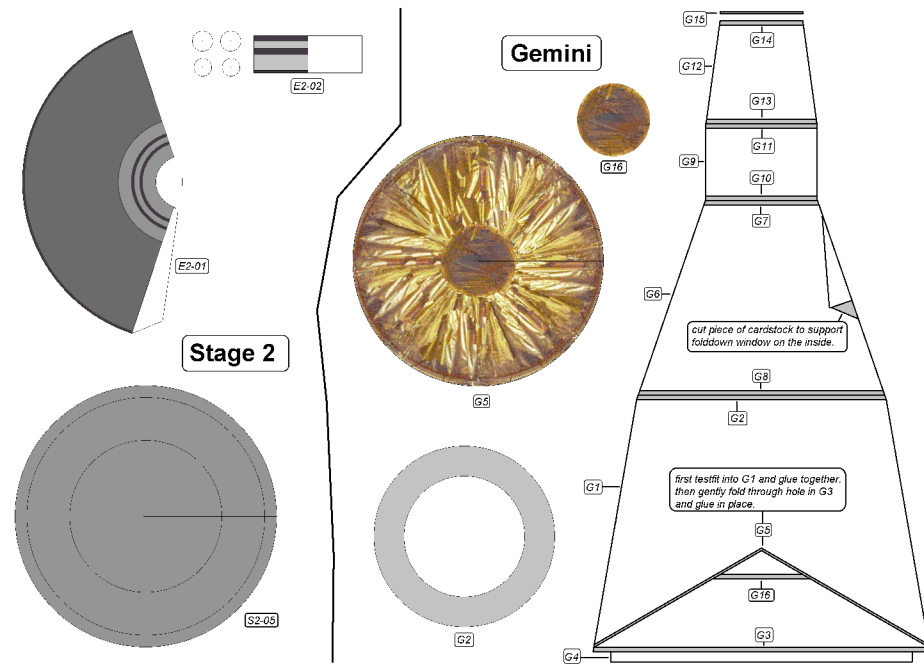

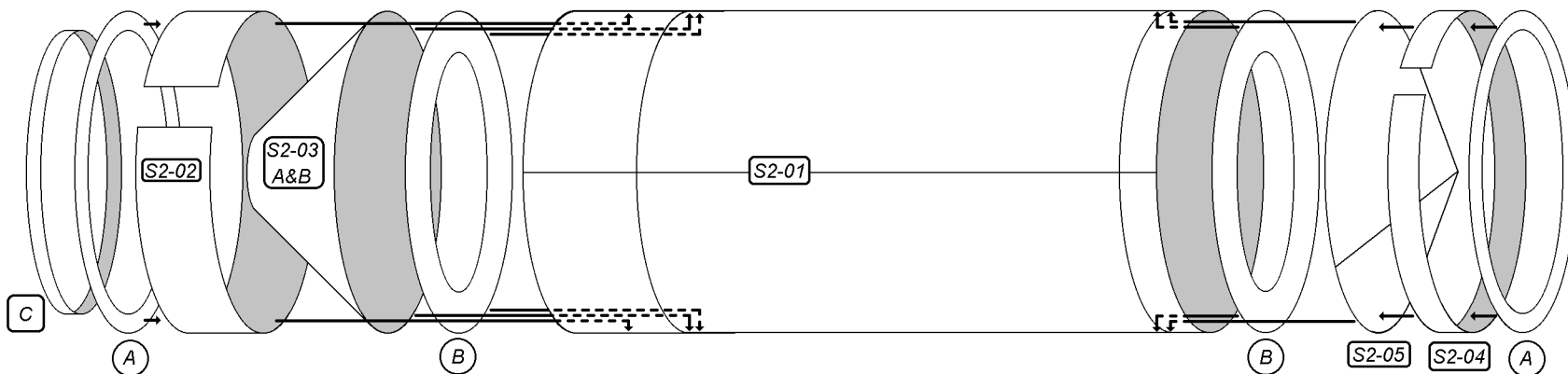
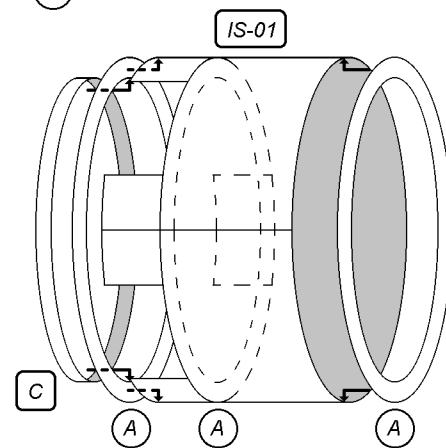
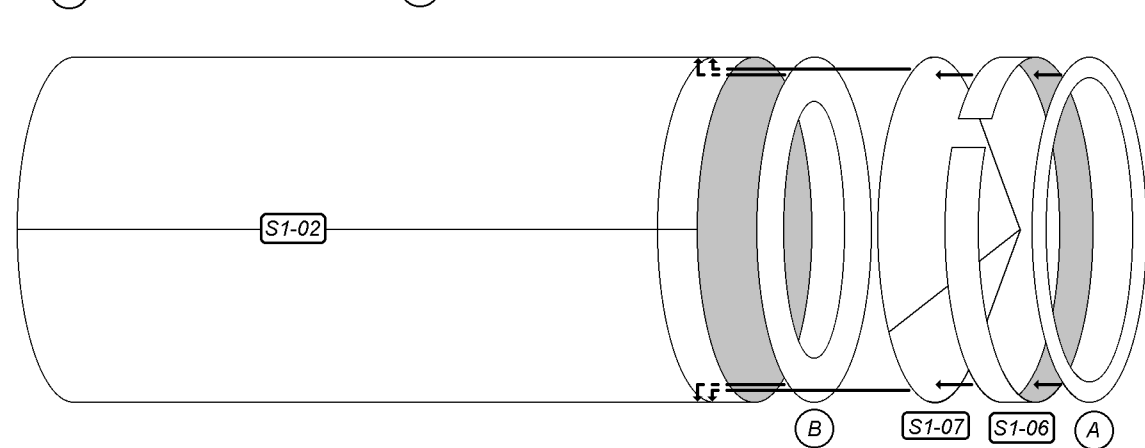
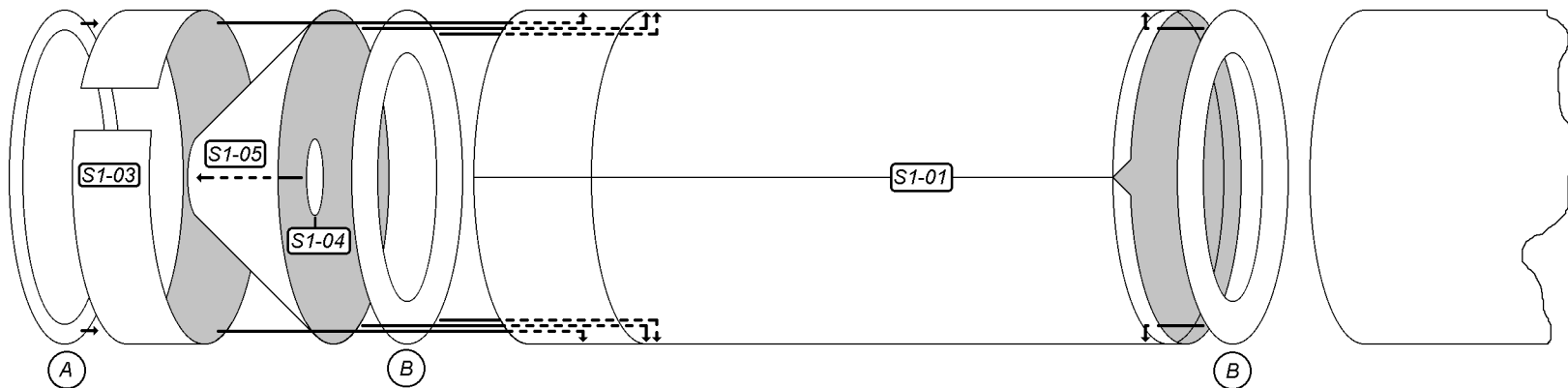

Titan II

Side

Front

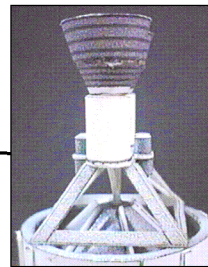

Engine Stage 2

NOTE

This model is a scaled down version of a 1:48 model.
some parts , in this 1:96 version , are
so small that they can be left out.

This model is an aproximation of the real thing due to the properties of paper.

NOTE ; Cut 1mm square strips and reinforce with
superglue . cut to size and glue into place.

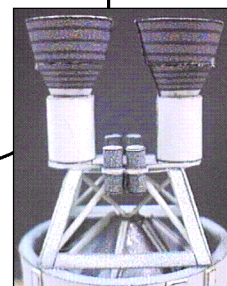

A

